

## **INSTALLATION GUIDE** **ConnectLine TV adapter** **Getting started**

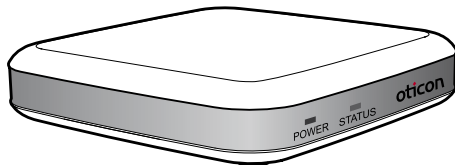

### READ THIS FIRST

Before your hearing instruments can receive the TV sound, the adapter must be connected to the TV and a power outlet.

This is an easy step-by-step guide through the installation of the TV adapter.

All needed parts for the installation are included in the package.

The connection parts are packed in numbered boxes from 1 to 3.  
The numbers refer to each step in the installation.

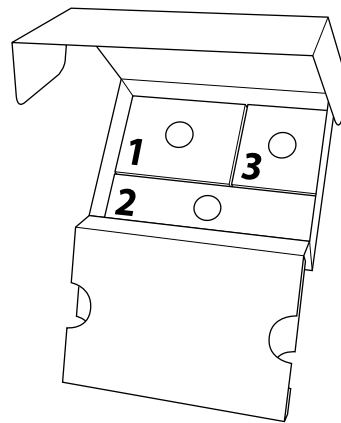

## TV ADAPTER OVERVIEW

Back

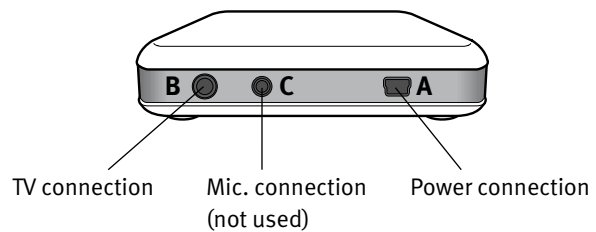

Front

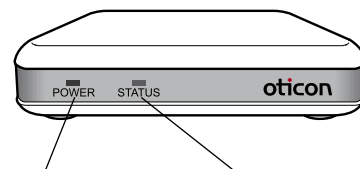

### POWER INDICATOR

Light	Meaning
Solid	Power on
Off	Power off

### STATUS INDICATOR

Light	Meaning
Solid	Connected to Streamer and streaming TV sound
Off	Stand-by
Flashing	Pairing

## CONNECTING TO POWER

Start by connecting the TV adapter to a power outlet.

Use the Power adapter from box no. **1**.

- Plug the power adapter into the wall socket or another power source.
- Plug the power cord into the power connection marked **A**.
- Check that power is turned on and there is a solid green light in the Power indicator on the front of the TV adapter.

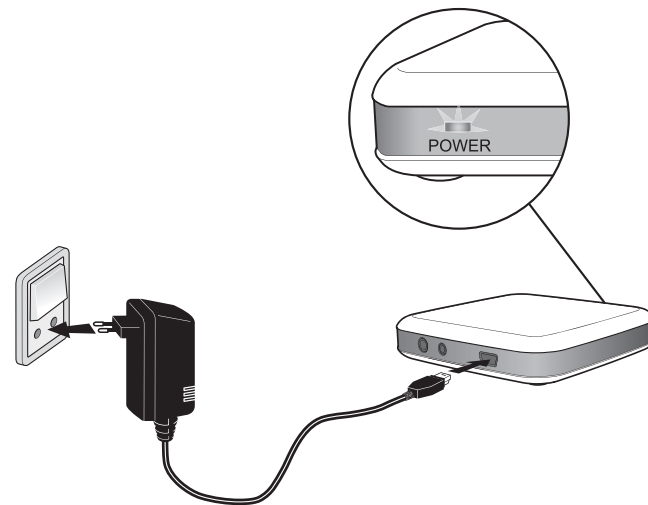
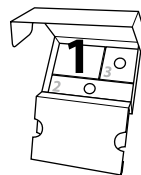



## CONNECTING TO TV

Connect the TV adapter to the TV. Use the TV cord from box no. **2**.

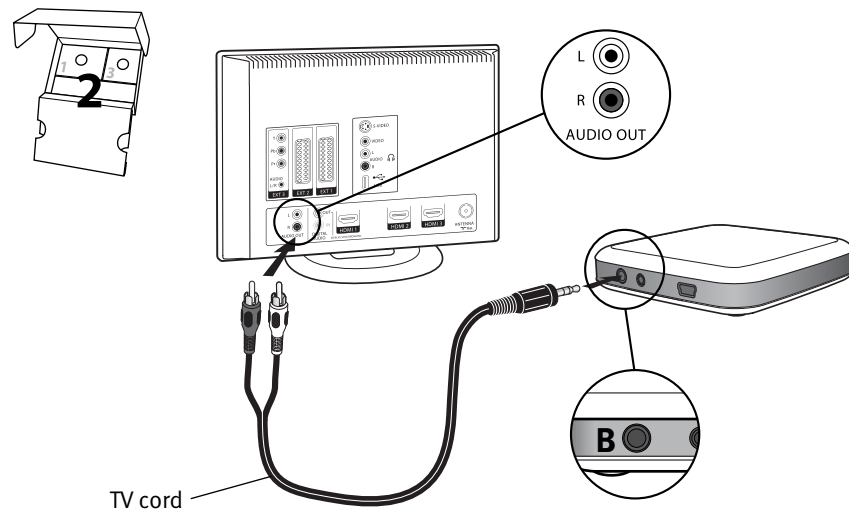
- Connect the black plug on the TV cord to the connector marked **B**.
- Connect the red and white connectors to the "AUDIO OUT" terminals on the TV.  
(typically marked "L - R" "AUDIO OUT" and found on the TV back or bottom panel).





---

**If the TV has is no “L - R” RCA Phono “OUTPUT”, an adapter should be used for connecting the TV cord. Proceed to next page.  
Otherwise go to page 16 for PAIRING.**

The adapter are found in box no. **3**.  
(If installation completed in step 2, box no. **3** is not used!)

SCART CONNECTION using the SCART adapter.

- Connect the Audio cord to the red and white terminals on the SCART adapter and plug it into the TV's SCART connection.

If you have a DVD or a Sat box connected to the SCART, you should use option 2 instead (Headphone connection, next page).

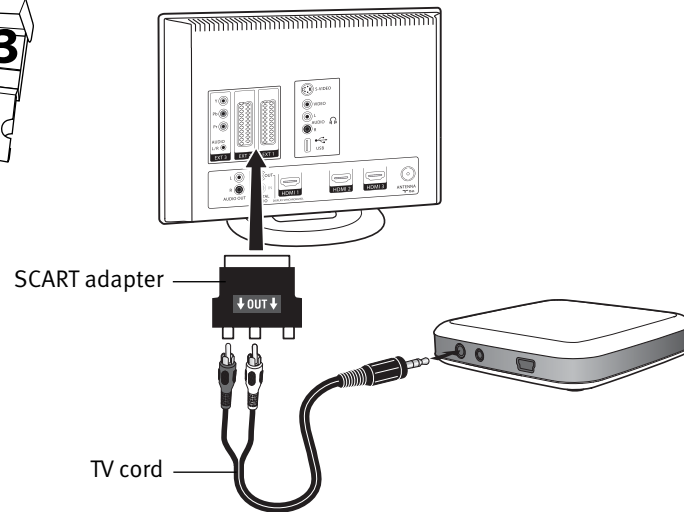
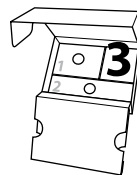

## OPTIONAL ADAPTERS FOR CONNECTING TO TV

HEADPHONE CONNECTION using the Jack adapter.

- Connect the TV cord to the jack adapter and plug it into the TV's headphone output.

The headphone output may be found on the side or front of the TV.

*Notice: The TV speakers may be muted when connecting to the headphone output.  
Sound will only come via TV adapter.*

## OPTION 2: HEADPHONE CONNECTION

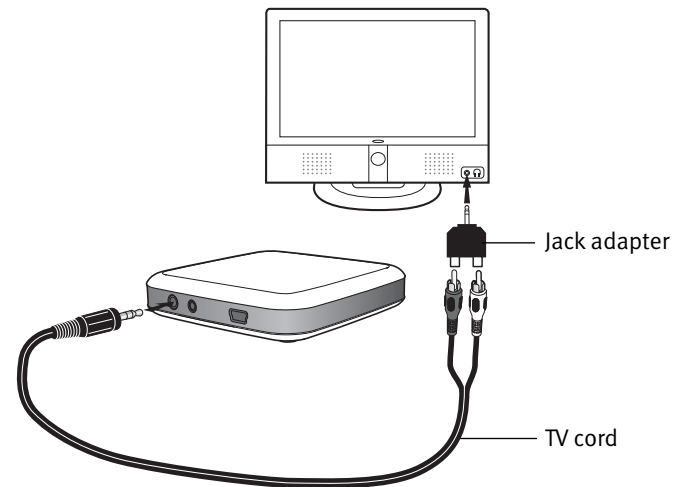
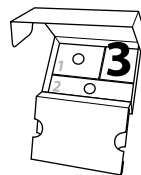

The very first time your Streamer is used with the TV adapter, the two devices must be paired together.

### PAIRING:

1. When pairing, the devices must be placed close together. Place the Streamer right next to the TV adapter (less than 30 cm /1 ft between devices).
2. Press and hold the Streamer Connect button for 5 seconds until the blue light starts flashing rapidly.
3. The two devices establish a connection to each other. Wait one minute.
4. After one minute the TV adapter is connected to Streamer and pairing is complete. The orange STATUS indicator on the TV adapter lights up.

Pairing is done only once and will normally not have to be repeated.



 STATUS

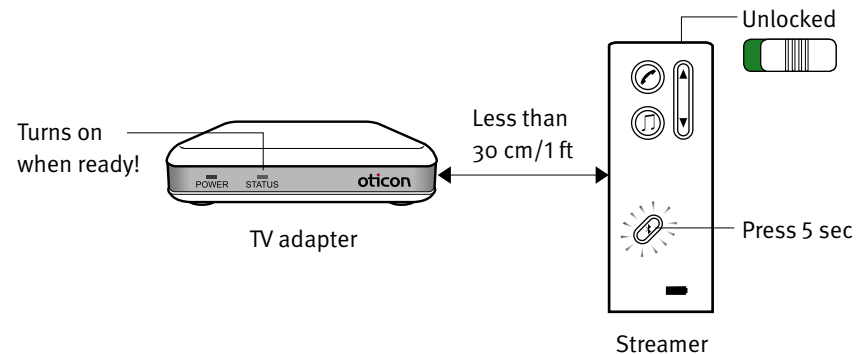

Place the TV adapter in a suitable spot close to the TV. For using the Streamer with the TV adapter, refer to the user guide.

### **Turn off the TV adapter**

The TV adapter uses very little power so it is not necessary to turn it off .

### **TV sound range**

TV adapter has a range of about 10 meters depending on furnitures and placement.

### **Connection with SCART adapter**

If you connect the TV adapter with the SCART adapter you will only hear audio from the TV tuner with TV adapter. Audio from other sources such as DVD or VCR will not be played in the hearing instruments. This is a limitation of the SCART connector.

For further support or tips you can check the ConnectLine information on [www.oticon.com/connectline](http://www.oticon.com/connectline)

## PRODUCT APPROVAL PRECAUTIONS AND MARKINGS

This device complies with Part 15 of the FCC Rules.

Operation is subject to the following two conditions: (1) this device may not cause interference, and (2) this device must accept any interference, including interference that may cause undesired operation of the device.

Changes or modifications not expressly approved by the party responsible for compliance could void the user's authority to operate the equipment.

To comply with FCC RF exposure requirements, the device and the antenna for this device must be installed to ensure a minimum separation distance of 20 cm or more from a person's body. Other operating configurations should be avoided.

**NOTE:** *This equipment has been tested and found to comply with the limits for a Class B digital device, pursuant to Part 15 of the FCC Rules. These limits are designed to provide reasonable protection against harmful interference in a residential installation. This equipment generates, uses and can radiate radio frequency energy and, if not installed and used in accordance with the instructions, may cause harmful interference to radio communications. However, there is no guarantee that interference will not occur in a particular installation.*

*If this equipment does cause harmful interference to radio or television reception, which can be determined by turning the equipment off and on, the user is encouraged to try to correct the interference by one or more of the*

*following measures:*

- *Reorient or relocate the receiving antenna.*
- *Increase the separation between the equipment and receiver.*
- *Connect the equipment into an outlet on a circuit different from that to which the receiver is connected.*
- *Consult the dealer or an experienced radio/TV technician for help.*

Oticon hereby declares that this TV adapter, TV 75-01 is in compliance with the essential requirements and other relevant provisions of Directive 1999/5/EC.

Declaration of conformity is available at:

Oticon A/S  
Kongebakken 9  
DK-2765 Smørum  
Denmark  
[www.oticon.com](http://www.oticon.com)

CE 0678



Waste from electronic equipment must be handled according to local regulations.

Use the following switch mode power supply with your TV adapter: Fuhua, Model No. UE10W-050020SPC, Input: 100-240V AC 150mA 50-60Hz, Output: 5V DC 200mA



## WARNINGS



The TV adapter is not a toy and therefore should be kept out of the reach of children and anyone else who might swallow parts or otherwise cause injury to themselves. Special attention should be paid to the smaller components in order to prevent children from swallowing them and choking.

*If a part is swallowed, see a doctor immediately.*

The safety of the use of the TV adapter with an auxiliary input cable is determined by external signal source. When the input cable is connected to mains operated equipment, this equipment must comply with IEC-60065, IEC-60601 or equivalent safety standards.

The TV adapter is designed to comply with the most stringent Standards of International Electromagnetic Compatibility. However, the TV adapter might cause interference with other medical devices. Please contact relevant personnel to obtain a permission before using the TV adapter in hospitals or similar venues.

