



**USER GUIDE**  
**Phone calls**  
**Daily use**

**INTRO**

The Phone solution is a wireless connection between your Streamer and a landline analog phone which allows for remote phone conversations.

The Phone solution supports both incoming and outgoing phone calls. During a phone call the hearing instruments are used as head sets and the body worn Streamer which enables hands free operation.

First, make sure that the Phone adapter is correctly connected to both the landline phone and the power adaptor. Refer to the installation guide. This user guide explains how Streamer is used for phone conversations.

The wireless Phone solution is possible within a range of approx. 30 feet from the Phone adapter.



**STREAMER OVERVIEW**

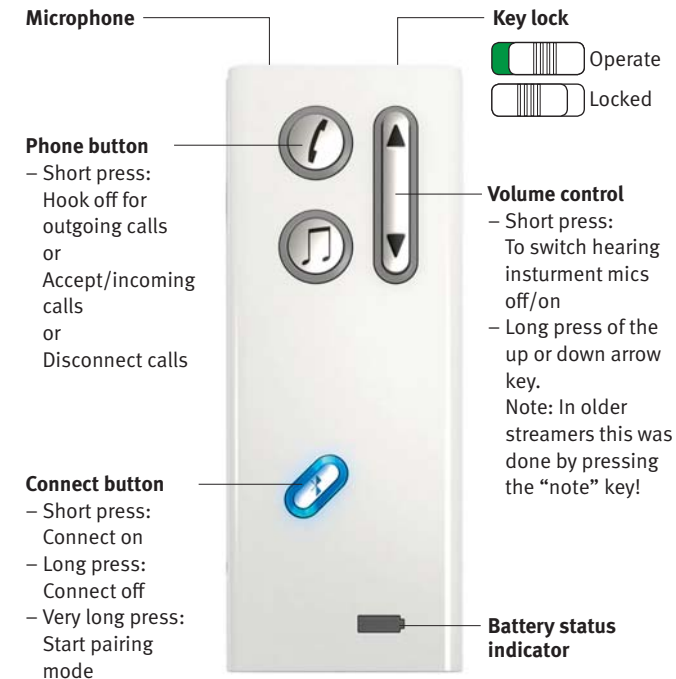

*Phone calls can be recieved also when keys are locked!*

## INCOMING CALLS

### Before talking

Wear the Streamer around your neck using the neck strap. Make sure the Connect function on the Streamer is switched on. You must be within 30 feet from the Phone adapter and its red status indicator must show constant light.

### Incoming calls

A ringing tune is heard in the hearing instruments and the green rim light around the Phone button flashes.



### Answer

Press Streamer's Phone button shortly.

Streamer answers the call and the green rim light will switch to constant light. The call is now directed into the hearing instruments. Talk normally, as if the other person was sitting in front of you.



The red status indicator on the Phone adapter flashes during the call.



### Hang up

Press Streamer's Phone button shortly. Streamer hangs up the call and the green rim light turns off.



The red status indicator on the Phone adapter switches to constant light.



## OUTGOING CALLS

### Make outgoing call

Use a short press to Streamer's Phone button (or shortly press the red Phone button on the Phone adapter).



The hook is off and you will hear a dial tone in the hearing instruments. The green rim light shows constant light in Streamer's Phone button.



Pick up the receiver (or press Call on the portable phone) and dial the wished phone number. Put the receiver back on (or press End Call on the portable phone)

The red status indicator on the Phone adapter flashes during the call.



STATUS

### Hang up

Use a short press on Streamer's Phone button. Streamer disconnects the call and the green rim light turns off.



The red status indicator on the Phone adapter switches to constant light.



STATUS

*Make sure that the portable phone is turned off again, or the receiver is back on!*

## ADJUSTING VOLUME

Use the Volume button on Streamer to adjust the phone volume level in the hearing instruments.



Use a short press to adjust the volume Up or Down. Repeat the **short press** to do further adjustments.



The phone volume level set by Streamer is memorized.

Next time a phone call is made, the memorized volume level will be applied.

*Notice: Your voice level to the receiving person is automatically adjusted by Streamer, but you should always speak loud and clear and if necessary into the microphone of Streamer.*

## LISTENING TIP

### HEAR PHONE CONVERSATIONS ONLY

First time using the Phone application, the hearing instrument microphones are default to on.

The hearing instrument microphones can be muted allowing you to better hear the phone conversation.

This is done by pressing the Volume button either Up or Down for **A 2 seconds**.



2 SEC

Pressing the Volume button for 2 seconds again during the conversation, activates the hearing instrument microphones.

For detailed user instructions on Streamer, refer to the Streamer manual.

Further relevant tips and support can be found on [www.oticon.com/connectline](http://www.oticon.com/connectline)