

Oticon ♦ ConnectLine

PC

Music

Phone

TV

Mobile

Remote

Introducing ConnectLine™

System overview

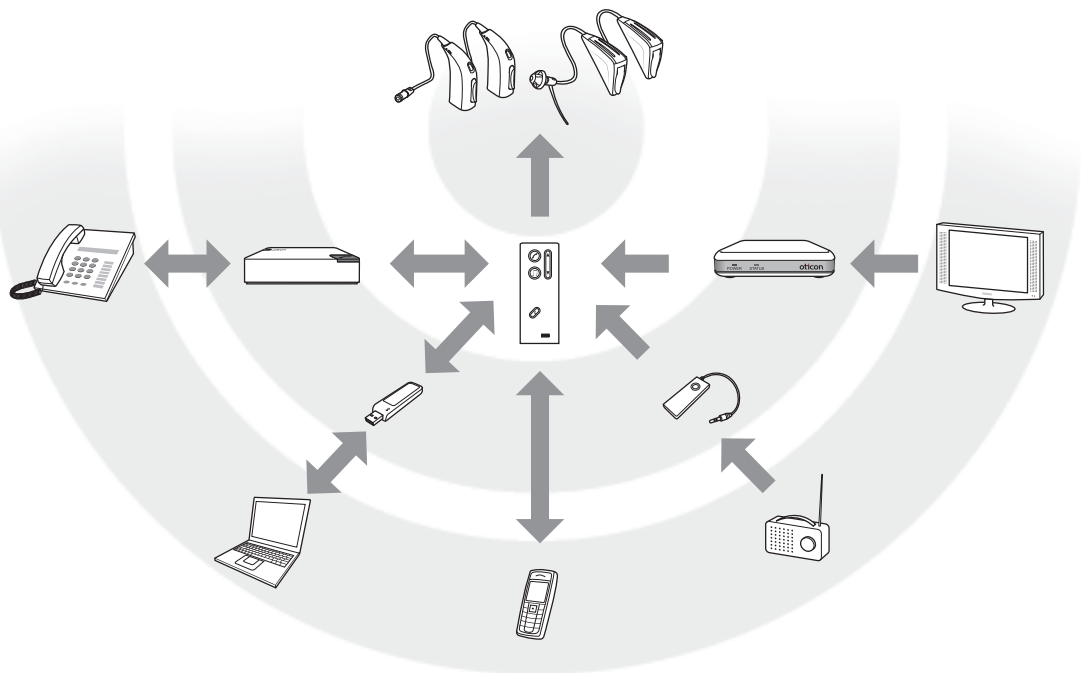

ConnectLine™ - Say hello to life

ConnectLine is entertainment, information and communication for hearing aid users on equal terms with everybody else.

For hearing care professionals it's the no-nonsense key to making phones, TVs, music, radios, PC-sound and other long sought-after content available for people with a hearing loss.

Client satisfaction is directly related to the number of situations in which the client can participate like everybody else. That is exactly what ConnectLine facilitates.

A complete system

If you can push a button, you can use ConnectLine. Because everything has been engineered to work as a system, both ease of operation and seamless integration are facts of life. The TV and phone solutions work perfectly together or as individual, stand alone connections, depending on the user's needs.

No matter whether the user has one or many connections, the result is the same. By sending sound directly to their hearing instruments, audibility is significantly improved. It's much like FM and T-coil, only this is more flexible, easier to use and costs less.

ConnectLine™

- Easy access to excellent audibility when watching TV, using a phone or listening to the radio
- A user friendly system designed with the user's needs in mind
- A driver of user satisfaction, because the user's communication capabilities are notably enhanced



TV



The ConnectLine™ TV adapter is connected to an audio output on the TV

The TV adapter transmits sound to the hearing instruments via the Oticon Streamer within a range of up to 30 feet

It's easy to operate, just push a button on the Oticon Streamer to get clear and undistorted sound directly in both ears



ConnectLine™ TV

With ConnectLine TV you can offer a better TV sound solution than just hearing instruments alone. For the client this entails high sound quality, and for the rest of family it means TV at normal volume level.

The TV adapter transmits sound directly to the hearing instruments, resulting in improved audibility. A clinical test with 10 users shows an increase in speech intelligibility from 36% to 81% when comparing using hearing instruments alone to using ConnectLine TV.

Enjoy the TV a lot more

Because ConnectLine TV is part of the ConnectLine system, your clients can enjoy TV a lot more.

Firstly, because of the improved sound quality. And secondly, because they can relax knowing that the integrated system will notify them with a sound signal directly in their hearing instruments if the landline or mobile phone should ring.

ConnectLine TV is:

- An Oticon developed, high sound quality wireless technology that eliminates echo and lip sync problems seen in most other Bluetooth TV solutions
- Improved audibility and speech intelligibility
- Part of a system allowing for easy switching between TV sound, phone calls and other sound sources at will

Phone



The ConnectLine™ Phone adapter works in parallel with an existing landline phone

The Phone adapter creates a wireless link to the hearing instruments via the Oticon Streamer and operates within a range of 30 feet

It's easy to operate, just push a button on the Oticon Streamer to get clear and undistorted sound directly in both ears

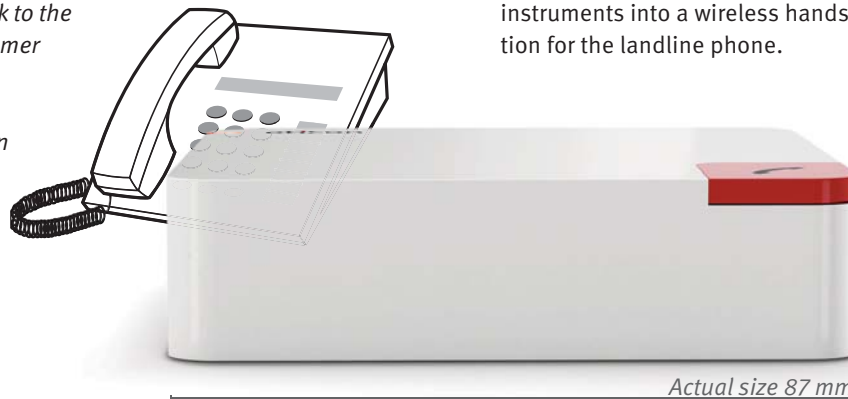

Actual size 87 mm

ConnectLine™ Phone

Using a traditional phone is at best a hassle, and at worst impossible for hearing instrument users.

With ConnectLine Phone this is no longer the case. Stress-free phone conversations are now possible thanks to the ConnectLine Phone adapter, which interfaces to the phone line and wirelessly connects to the hearing instruments through the Oticon Streamer. Streamer has a built-in microphone – in effect turning a pair of hearing instruments into a wireless hands free solution for the landline phone.

Calls are welcome

Answering the call is as simple as pushing the phone button on the Streamer, also when sitting on the couch up to 30 feet away from the Phone adapter.

Using ConnectLine Phone is worry free. Once configured, all it requires to work is to be in range of the phone adapter with the Streamer turned on.

ConnectLine Phone is:

- Improved speech intelligibility without howling or other artifacts
- No need to get up to answer the phone – just push the button on the Streamer
- An integral part of ConnectLine; hence the user can be alerted to phone calls e.g. when watching TV

Mobile



Practically all Bluetooth enabled mobile phones can connect wirelessly to the Oticon Streamer

It's easy to operate, just push one button on the Oticon Streamer to answer or end a call

ConnectLine™ Mobile

Oticon Streamer can connect directly to almost any mobile phone on the market. The built-in microphone turns the user's hearing instruments into a high quality wireless hands free solution, making mobile phones accessible and convenient to use for the hearing impaired.

Freedom of speech

Sending the sound directly to the hearing instruments and using the microphone in the Streamer eliminates howling and greatly improves sound quality and speech intelligibility.

This has to be a very invigorating experience for the hearing instrument user, and maybe even the first time ever that mobile phone conversations become a part of everyday life.

ConnectLine Mobile is:

- High sound quality and improved speech intelligibility
- A new sense of freedom from being able to communicate on the move
- An integral part of ConnectLine, meaning that the hearing instruments will alert the user to an incoming call, also when watching TV
- For some it's a way to handle the widespread prohibition against using handheld phones when driving a car

More

Other solutions

The Oticon Streamer is a universal gateway allowing many different applications to be part of the ConnectLine system:



PC - Wireless Headset

More and more people are using PCs for internet telephony video conferencing. Connecting the Oticon Streamer to a PC wirelessly turns a pair of hearing instruments into a wireless headset.



Music - Wireless Headphones

The Streamer offers a connection to radios, PCs, mp3 players etc. either wirelessly or via a cable, thereby turning the hearing instruments into a discreet headphone.

Remote Control

The Oticon Streamer is also an advanced remote control for the hearing instruments, allowing clients to adjust the volume and switch between programs.

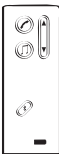

ConnectLine™ at a glance

ConnectLine is a user friendly communication system that offers more clients a better care plan and increased satisfaction with their hearing instruments.

ConnectLine is a new dimension in hearing care and an effective way to help people live the life they want with the hearing they have.

ConnectLine is:

- Engineered and designed as a complete and integrated system with focus on removing barriers, intuitive operation and high sound quality
- ConnectLine takes care of the connections so the user can focus on the content, be it a movie, a phone call or a radio program
- The user will not have to remember repetitive set-up and configuration menus and processes. Once set up, ConnectLine works as soon as the devices are within reach (30 feet)
- Each of the solutions in the ConnectLine system deliver increased sound quality and improved speech intelligibility compared to hearing instrument only solutions

People First

We believe that it takes more than technology and audiology to create the best hearing instruments. That's why we put the individual needs and wishes of people with hearing loss first in our development of new hearing care solutions.